



JAMES
ANDERSON

Borneo Street
London SW15

Offers In Excess Of £800,000



Borneo Street London SW15

Flooded with natural light and brimming with character, this beautifully presented two double bedroom ground floor period apartment offers an exceptional blend of timeless charm and contemporary comfort. Spanning an impressive 846sqft, the property is wonderfully bright, airy and impeccably well proportioned throughout, enhanced by high ceilings, elegant period features, and a calming palette of neutral colour tones that create an inviting and harmonious atmosphere.

A welcoming own front door opens into the spacious accommodation, where a generous reception room immediately sets the tone. Framed by classic period shutters, this elegant living space boasts a striking feature fireplace with a log burner, perfect for creating a warm and cosy ambience.

Both double bedrooms are thoughtfully positioned and offer ample space, excellent natural light, and a peaceful feel, making them ideal retreats at the end of the day. The sleek, luxury three-piece shower room has been finished to a high standard, combining style with practicality.

To the rear of the apartment lies a superb open plan kitchen and dining area, designed for modern living. This beautifully arranged space provides abundant storage, high-quality fittings, and seamless flow, opening directly onto the property's standout feature: a private and secluded rear garden. Wrapped in greenery, the garden feels wonderfully calm and private, a lovely spot for relaxed outdoor meals, pottering with plants, or simply taking a quiet moment to unwind.

Presented in excellent condition and offering an exceptional amount of space, character and light, this stunning period home is a truly rare find combining modern convenience with classic style, all on the coveted ground floor with the benefit of its own entrance and a delightful private garden.

Tenure - Share Of Freehold (986 years within lease)

EPC Rating - D

Council Tax Band - E

GR & SC - Peppercorn

















Borneo Street

Approximate Gross Internal Area = 846 sq ft / 78.6 sq m



JAMES
ANDERSON

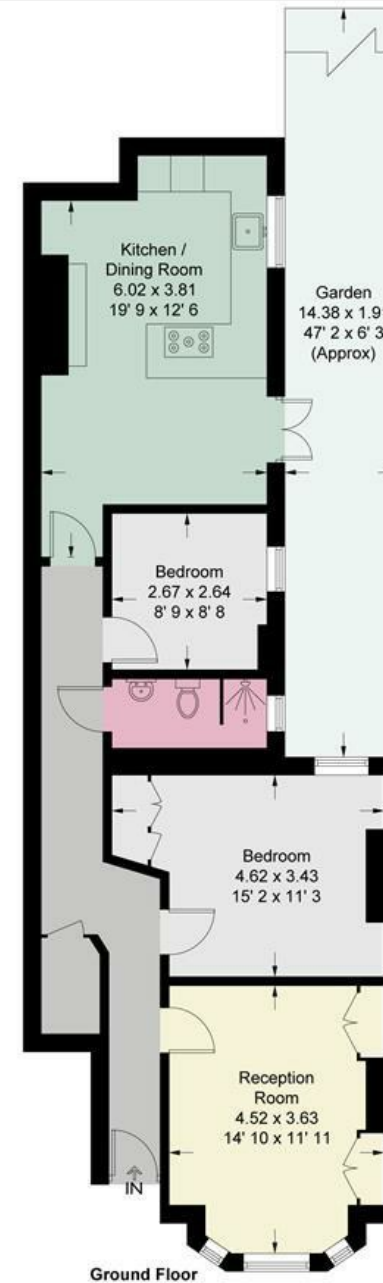

JAMES
ANDERSON

This plan is not to scale and must be used as layout guidance only. All measurements and areas are approximate and should not be relied upon to provide accurate information. This plan must not be relied upon when making property valuations, design considerations or any other such relevant decisions. We accept no responsibility or liability (whether in contract, tort or otherwise) in relation to any loss whatsoever arising from or in connection with any use of this plan or the adequacy, accuracy or completeness of it or any information within it.





78 Lower Richmond Road
Putney
SW15 1LL

020 8788 6611
sales@japutney.co.uk
www.jamesanderson.co.uk

